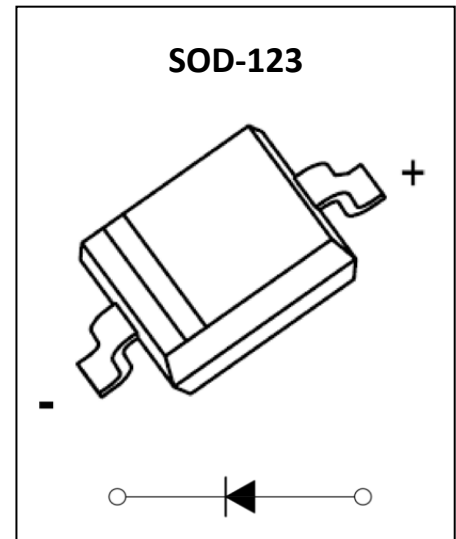
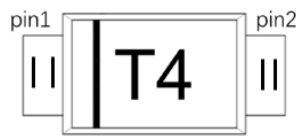
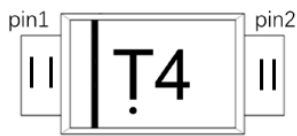

1N4148W Fast Switching Diodes
Feature

- Fast Switching Speed
- High Conductance
- For General Purpose Switching Applications

MARKING:

ABSOLUTE MAXIMUM RATINGS (T_A=25°C unless otherwise noted)

Parameter	Symbol	Value	Unit
Non-Repetitive Peak Reverse Voltage	V _{RM}	100	V
Repetitive Peak Reverse Voltage	V _{RRM}	100	V
Working Peak Reverse Voltage	V _{RWM}		
DC Blocking Voltage	V _R		
RMS Reverse Voltage	V _{R(RMS)}	71	V
Mean rectifying current	I _O	0.15	A
Forward Continuous Current	I _{FM}	0.3	A
Non-repetitive Peak Forward Surge Current @ t=1 us	I _{FSM}	2	A
Power Dissipation	P _D	0.35	W
Junction Temperature	T _J	150	°C
Storage Temperature	T _{STG}	-55 ~ +150	°C

ELECTRICAL CHARACTERISTICS (T_A=25°C unless otherwise noted)

Parameter	Symbol	Test Condition	Min	Max	Unit
Forward Voltage	V _F	I _F = 1mA		0.715	V
		I _F = 10mA		0.855	V
		I _F = 50mA		1.0	V
		I _F = 150mA		1.25	V
Reverse Current	I _R	V _R = 20V		25	nA
		V _R = 75V		1	μA
Diode Capacitance	C _D	V _R =0V, f=1MHz		2	pF
Reverse Recovery Time	t _{rr}	I _F =I _R =10mA, I _{rr} =0.1*I _R , R _L =100Ω		4	ns

Typical Electrical and Thermal Characteristics

Forward characteristics

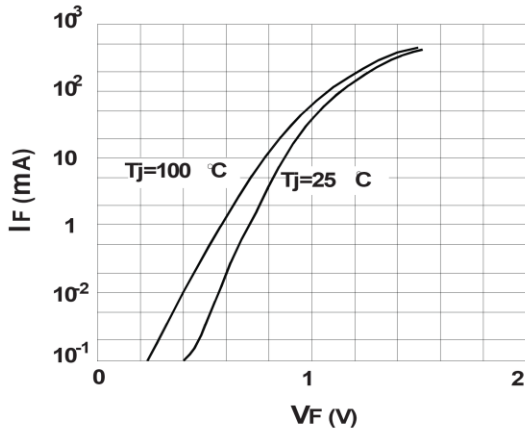

Dynamic forward resistance vs. forward current

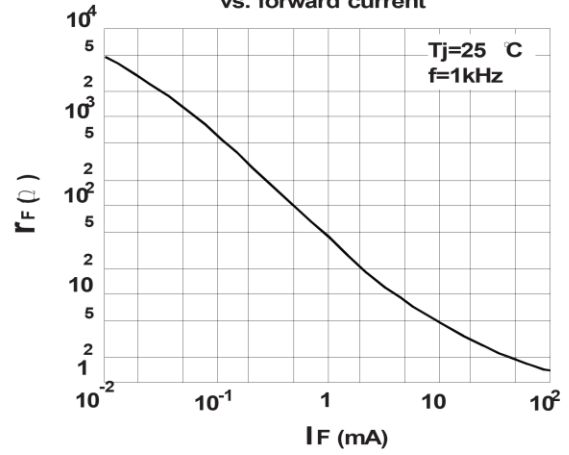

Reverse capacitance vs. reverse voltage

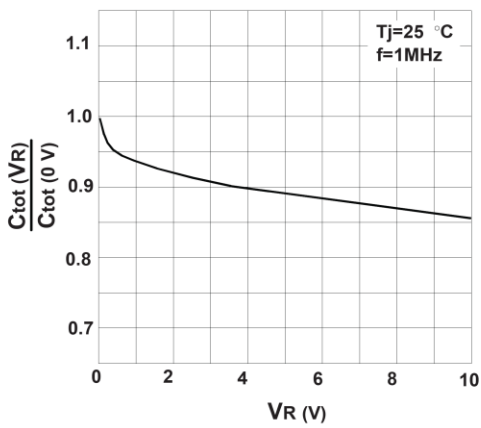

Ammissible repetitive peak forward current vs. pulse duration

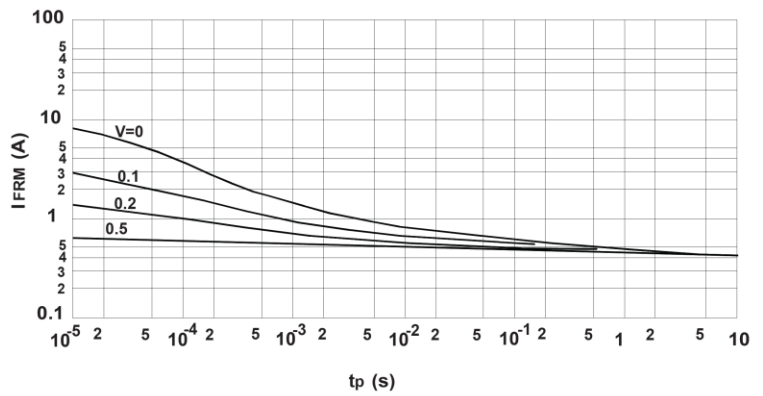

SOD-123 Package Outline Dimensions

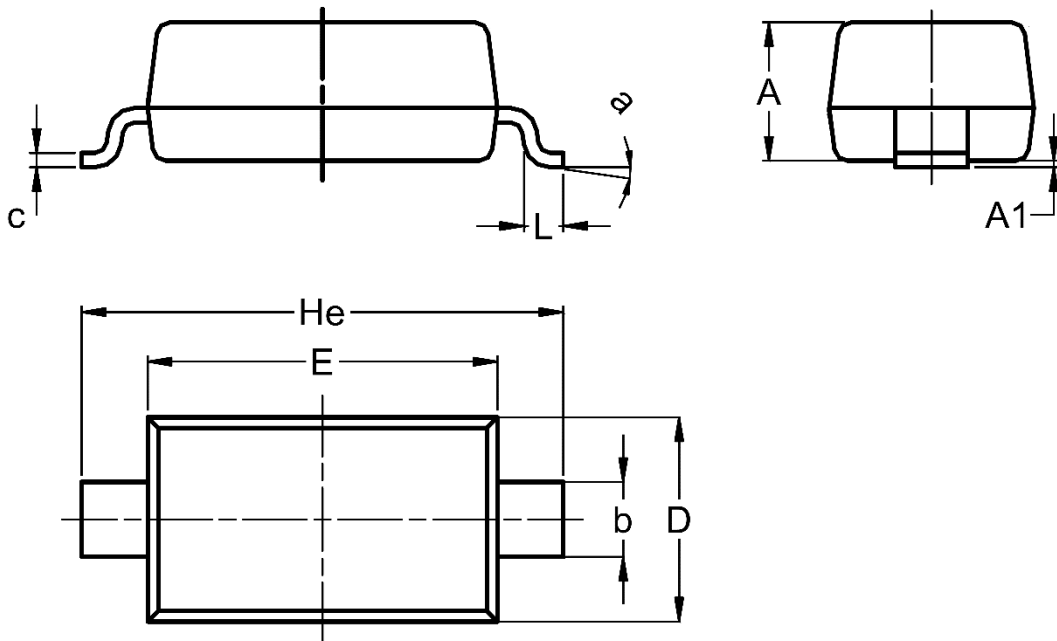

Symbol	Dimensions In Millimeters		Dimensions In Inches	
	Min.	Max.	Min.	Max.
A	0.950	1.350	0.037	0.053
A1	0	0.100	0	0.004
c	0.090	0.120	0.004	0.005
D	1.500	1.700	0.059	0.067
b	0.450	0.650	0.018	0.026
He	3.450	3.850	0.136	0.152
E	2.550	2.800	0.100	0.110
L	0.200	0.400	0.008	0.016
a	0°	8°	0°	8°